

| EXCHANGER SIZE | DIMENSIONS | | | | | | | | | | | |
|----------------|------------|------|---------|------|---------|------|--------|------|--------|-----|--------|----|
| | A | | B | | C | | D | | (N1) | | (N2) | |
| | inches | mm | inches | mm | inches | mm | inches | mm | inches | mm | inches | mm |
| WS-102-2-1 | 30 1/8 | 765 | 12 1/2 | 318 | 4 1/2 | 114 | 26 | 660 | 4 | 102 | 1 1/2 | 38 |
| WS-103-2-1 | 42 1/8 | 1070 | 24 1/2 | 622 | 16 1/2 | 419 | 38 | 965 | 4 | 102 | 1 1/2 | 38 |
| WS-104-2-1 | 54 1/8 | 1375 | 36 1/2 | 927 | 28 1/2 | 724 | 50 | 1270 | 6 | 152 | 2 | 51 |
| WS-105-2-1 | 66 1/8 | 1680 | 48 1/2 | 1232 | 40 1/2 | 1029 | 62 | 1575 | 6 | 152 | 2 | 51 |
| WS-106-2-1 | 78 1/8 | 1984 | 60 1/2 | 1537 | 52 1/2 | 1334 | 74 | 1880 | 6 | 152 | 2 | 51 |
| WS-107-2-1 | 90 1/8 | 2289 | 72 1/2 | 1842 | 64 1/2 | 1638 | 86 | 2184 | 6 | 152 | 2 | 51 |
| WS-108-2-1 | 102 1/8 | 2594 | 84 1/2 | 2146 | 76 1/2 | 1943 | 98 | 2489 | 6 | 152 | 2 | 51 |
| WS-109-2-1 | 114 1/8 | 2899 | 96 1/2 | 2451 | 88 1/2 | 2248 | 110 | 2794 | 6 | 152 | 2 | 51 |
| WS-1010-2-1 | 126 1/8 | 3204 | 108 1/2 | 2756 | 100 1/2 | 2553 | 122 | 3099 | 6 | 152 | 2 | 51 |
| WS-1011-2-1 | 138 1/8 | 3508 | 120 1/2 | 3061 | 112 1/2 | 2858 | 134 | 3404 | 6 | 152 | 2 | 51 |
| WS-1012-2-1 | 150 1/8 | 3813 | 132 1/2 | 3366 | 124 1/2 | 3162 | 146 | 3708 | 6 | 152 | 2 | 51 |
| WS-1013-2-1 | 162 1/8 | 4118 | 144 1/2 | 3670 | 136 1/2 | 3467 | 158 | 4013 | 6 | 152 | 2 | 51 |
| WS-1014-2-1 | 174 1/8 | 4423 | 156 1/2 | 3975 | 148 1/2 | 3772 | 170 | 4318 | 6 | 152 | 2 | 51 |
| WS-1015-2-1 | 186 1/8 | 4728 | 168 1/2 | 4280 | 160 1/2 | 4077 | 182 | 4623 | 6 | 152 | 2 | 51 |

| NOZZLE SCHEDULE | | | | |
|-----------------|------|--------------|------|-------------|
| SERVICE | MARK | SHELL SIDE | MARK | TUBE SIDE |
| INLET | (N1) | AS PER TABLE | (N5) | 4 (102) NPT |
| OUTLET | (N2) | AS PER TABLE | (N6) | 4 (102) NPT |
| DRAIN | (N3) | 1/2 (13) NPT | | |
| VENT | (N4) | 3/4 (19) NPT | | |

- NOTES: 1. SUPPORTS SUPPLIED ONLY IF SPECIFIED ON ORDER.
 2. NOZZLE SIZES SHOWN ARE RECOMMENDED FOR MAXIMUM EXCHANGER LIFE.
 3. FABRICATED TO ASME CODE SECTION VIII DIVISION 1 AND LATEST ADDENDA.
 4. DRAWING IS NOT TO SCALE.
 5. ALL DIMN'S ±1/8 (3) UNLESS OTHERWISE SHOWN.

| DESIGN CONDITIONS | | | | |
|-------------------------|----------|----------|----------|----------|
| | SHELL | | TUBES | |
| DESIGN PRESSURE | 150 PSIG | 1034 KPa | 125 PSIG | 862 KPa |
| DESIGN TEMPERATURE | 375 °F | 191 °C | 375 °F | 191 °C |
| MIN. DESIGN METAL TEMP. | 35 °F | 1.7 °C | 35 °F | 1.7 °C |
| HYDRO. TEST PRESSURE | 225 PSIG | 1551 KPa | 250 PSIG | 1723 KPa |
| CONTENTS | STEAM | | WATER | |

CUSTOMER: _____
 LOCATION: _____
 ENGINEER: _____
 ORDER No.: _____
 PROJECT/JOB: _____
 LOCATION: _____
 TAG: _____ (QUOTE # _____)

| | | | | | | |
|--|-------------------|---------------------|---------------------|---------------------|------------------------|------|
| TITLE | A R M S T R O N G | | | | NUMBER | REV. |
| G.A. 150 LB. WS SERIES HEAT EXCHANGERS | TORONTO - CANADA | MONTREAL - CANADA | BUFFALO - N. Y. | COLCHESTER - U.K. | WS-10-2P-1 | |
| DATE: 12/01/94 | BY: D.C.R. | TEL: (416) 755-2291 | TEL: (514) 421-2424 | TEL: (716) 693-8813 | TEL: (44) 120-657-9491 | |



END SUCTION GENERAL PURPOSE PUMPS
Series C - Close Coupled
Models C825AP, C825AM, C830AP, C830AM
Pump Unit Dimensional Outline

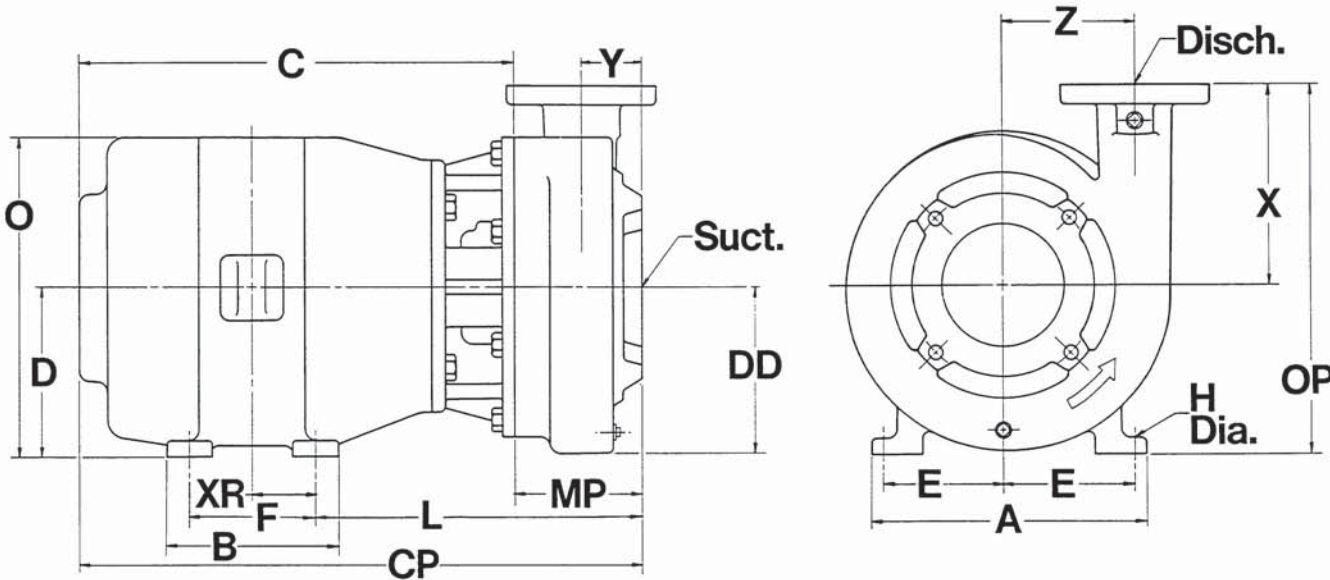

| COMMON DIMENSIONS C825AP and C825AM | | | | | | | | | | | | | | | SPECIFIC DIMENSIONS | | | | | | Approx. Wt. Lbs. | |
|--|--------------|---------------------------|----------|----------|----|----|-----|-----|----|----------|-----|----|----|----|---------------------|--------|----|-----|--------|----|------------------------|-----|
| Motor Frame | Suct. (1) | Disch. 125 lb. ANSI | A Max | B Max | D | E | F | H | MP | O Max | OP | XR | X | Y | Z | C825AP | | | C825AM | | | |
| 145 | 3 | 2½ | 7 | 6½ | 3½ | 2¾ | 5 | .34 | 3⅞ | 8¾ | 10¾ | 2½ | 7¼ | 2¼ | 4⅞ | 20¾ | 5¾ | 12⅞ | 17¾ | 5¾ | 9⅞ | 147 |
| 182 | 3 | 2½ | 9 | 6½ | 4½ | 3¾ | 4½ | .40 | 3⅞ | 9¾ | 11¾ | 2¼ | 7¼ | 2¼ | 4⅞ | 23¼ | 5¾ | 12⅞ | 20¼ | 5¾ | 9⅞ | 172 |
| 184 | 3 | 2½ | 9 | 7½ | 4½ | 3¾ | 5½ | .40 | 3⅞ | 9¾ | 11¾ | 2¾ | 7¼ | 2¼ | 4⅞ | 23¼ | 5¾ | 12⅞ | 20¼ | 5¾ | 9⅞ | 187 |
| 213 | 3 | 2½ | 10½ | 7½ | 5¼ | 4¼ | 5½ | .40 | 3⅞ | 11½ | 12½ | 2¾ | 7¼ | 2¼ | 4⅞ | 26¾ | 5¾ | 14¾ | 22¾ | 5¾ | 10¾ | 249 |
| 215 | 3 | 2½ | 10½ | 9 | 5¼ | 4¼ | 7 | .40 | 3⅞ | 11½ | 12½ | 3½ | 7¼ | 2¼ | 4⅞ | 27⅞ | 5¾ | 14¾ | 23⅞ | 5¾ | 10¾ | 281 |
| 254 | 3 | 2½ | 12½ | 10¾ | 6¼ | 5 | 8¼ | .53 | 3⅞ | 13¼ | 13½ | 4⅞ | 7¼ | 2¼ | 4⅞ | 30⅞ | 5¾ | 15¼ | 28⅞ | 5¾ | 12½ | 352 |
| 256 | 3 | 2½ | 12½ | 12½ | 6¼ | 5 | 10 | .53 | 3⅞ | 13¼ | 13½ | 5 | 7¼ | 2¼ | 4⅞ | 32⅞ | 5¾ | 15¼ | 29⅞ | 5¾ | 12½ | 423 |
| 284 | 3 | 2½ | 14 | 12½ | 7 | 5½ | 9½ | .53 | 3⅞ | 15 | 14¼ | 4¾ | 7¼ | 2¼ | 4⅞ | 32 | 5¾ | 15¼ | 29¼ | 5¾ | 12½ | 440 |
| 286 | 3 | 2½ | 14 | 14 | 7 | 5½ | 11 | .53 | 3⅞ | 15 | 14¼ | 5½ | 7¼ | 2¼ | 4⅞ | 33½ | 5¾ | 15¼ | 30¼ | 5¾ | 12½ | 503 |
| 324 | 3 | 2½ | 16 | 14 | 8 | 6¼ | 10½ | .65 | 3⅞ | 17 | 15¼ | 5¼ | 7¼ | 2¼ | 4⅞ | 35 | 5¾ | 15¼ | 32¼ | 5¾ | 13 | 629 |

| COMMON DIMENSIONS C830AP and C830AM | | | | | | | | | | | | | | | SPECIFIC DIMENSIONS | | | | | | Approx. Wt. Lbs. | |
|--|--------------|---------------------------|----------|----------|----|----|-----|-----|----|----------|-----|----|----|----|---------------------|--------|----|-----|--------|----|------------------------|-----|
| Motor Frame | Suct. (1) | Disch. 125 lb. ANSI | A Max | B Max | D | E | F | H | MP | O Max | OP | XR | X | Y | Z | C830AP | | | C830AM | | | |
| 182 | 4 | 3 | 9 | 6½ | 4½ | 3¾ | 4½ | .40 | 3⅞ | 9¾ | 12 | 2¼ | 7½ | 2½ | 5¼ | 23⅞ | 6½ | 12¾ | 20⅞ | 6½ | 9¾ | 184 |
| 184 | 4 | 3 | 9 | 7½ | 4½ | 3¾ | 5½ | .40 | 3⅞ | 9¾ | 12 | 2¾ | 7½ | 2½ | 5¼ | 23⅞ | 6½ | 12¾ | 20⅞ | 6½ | 9¾ | 199 |
| 213 | 4 | 3 | 10½ | 7½ | 5¼ | 4¼ | 5½ | .40 | 3⅞ | 11½ | 12¾ | 2¾ | 7½ | 2½ | 5¼ | 26¾ | 6½ | 14¾ | 22¼ | 6½ | 10¾ | 261 |
| 215 | 4 | 3 | 10½ | 9 | 5¼ | 4¼ | 7 | .40 | 3⅞ | 11½ | 12¾ | 3½ | 7½ | 2½ | 5¼ | 27⅞ | 6½ | 14¾ | 23¼ | 6½ | 10¾ | 293 |
| 254 | 4 | 3 | 12½ | 10¾ | 6¼ | 5 | 8¼ | .53 | 3⅞ | 13¼ | 13¾ | 4⅞ | 7½ | 2½ | 5¼ | 30⅞ | 6½ | 15¼ | 28 | 6½ | 12¾ | 364 |
| 256 | 4 | 3 | 12½ | 12½ | 6¼ | 5 | 10 | .53 | 3⅞ | 13¼ | 13¾ | 5 | 7½ | 2½ | 5¼ | 32⅞ | 6½ | 15¼ | 29¾ | 6½ | 12¾ | 435 |
| 284 | 4 | 3 | 14 | 12½ | 7 | 5½ | 9½ | .53 | 3⅞ | 15 | 14½ | 4¾ | 7½ | 2½ | 5¼ | 32 | 6½ | 15¼ | 29¾ | 6½ | 12¾ | 452 |
| 286 | 4 | 3 | 14 | 14 | 7 | 5½ | 11 | .53 | 3⅞ | 15 | 14½ | 5½ | 7½ | 2½ | 5¼ | 33½ | 6½ | 15¼ | 30¾ | 6½ | 12¾ | 515 |
| 324 | 4 | 3 | 16 | 14 | 8 | 6¼ | 10½ | .65 | 3⅞ | 17 | 15½ | 5¼ | 7½ | 2½ | 5¼ | 35 | 6½ | 15¼ | 32¾ | 6½ | 12¾ | 641 |
| 326 | 4 | 3 | 16 | 15½ | 8 | 6¼ | 12 | .65 | 3⅞ | 17 | 15½ | 6 | 7½ | 2½ | 5¼ | 36½ | 6½ | 15¼ | 33⅞ | 6½ | 12¾ | 704 |

(1) Equivalent to 125 lb. ANSI

CUSTOMER _____ JOB NAME _____
 P.O. NUMBER _____ ITEM NO. _____
 S.O. NUMBER _____ SERIAL NUMBER _____
 MOTOR MFR. _____ ENCL. _____ FRAME _____ HP. _____ VOLTS _____ PH. _____ HZ. _____
 PUMP SERIES TYPE STYLE _____ RPM _____ GPM _____ TOTAL HEAD IN FEET _____
 CERTIFIED FOR APPROVAL CONSTRUCTION BY _____ DATE _____

Subject to change unless certified for construction



Peerless Pump Company
Indianapolis, IN 46207-7026

END SUCTION PUMPS
Series C&F Type 825A Size 2½x3x8

SECTION 2340

1750 RPM

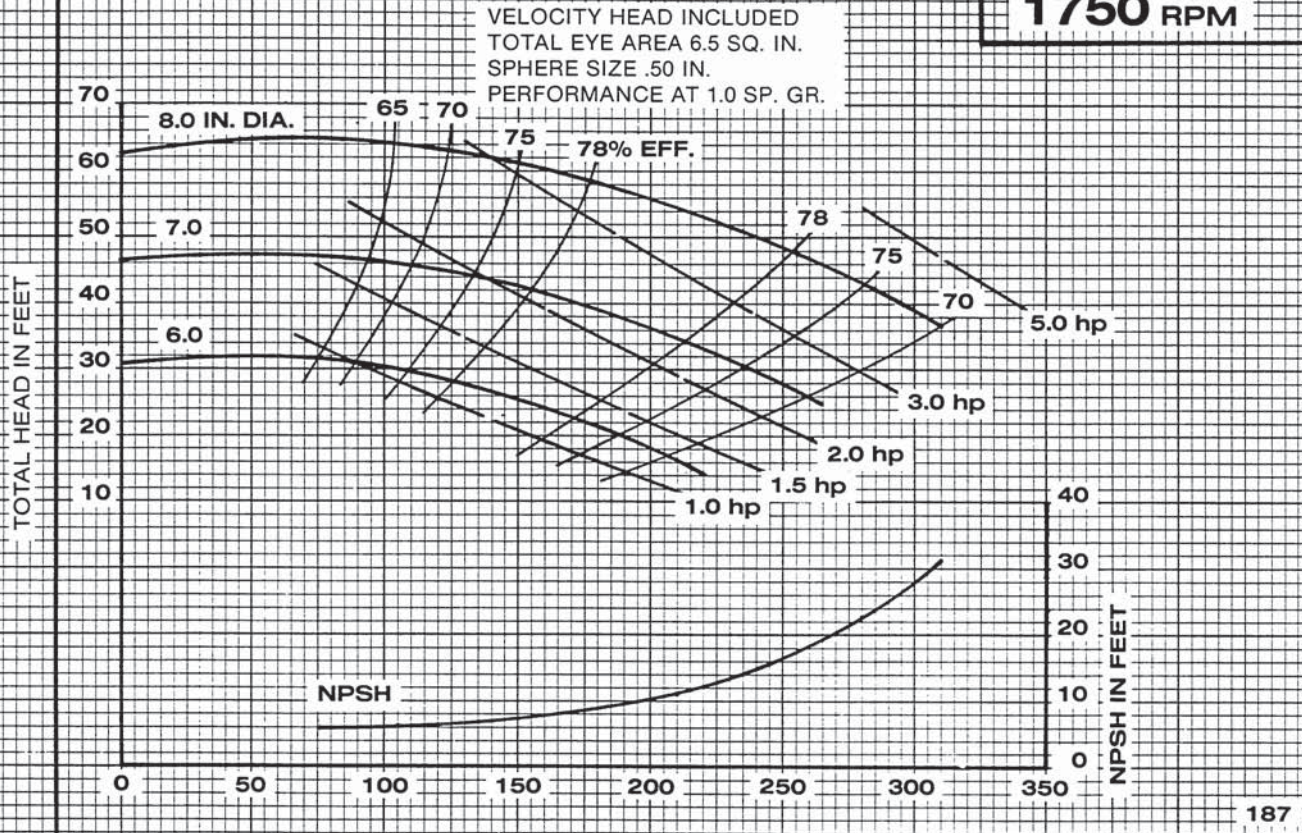

IMPELLER **2683738**

U.S. GALLONS PER MINUTE

CURVE **3115060**

3500 RPM

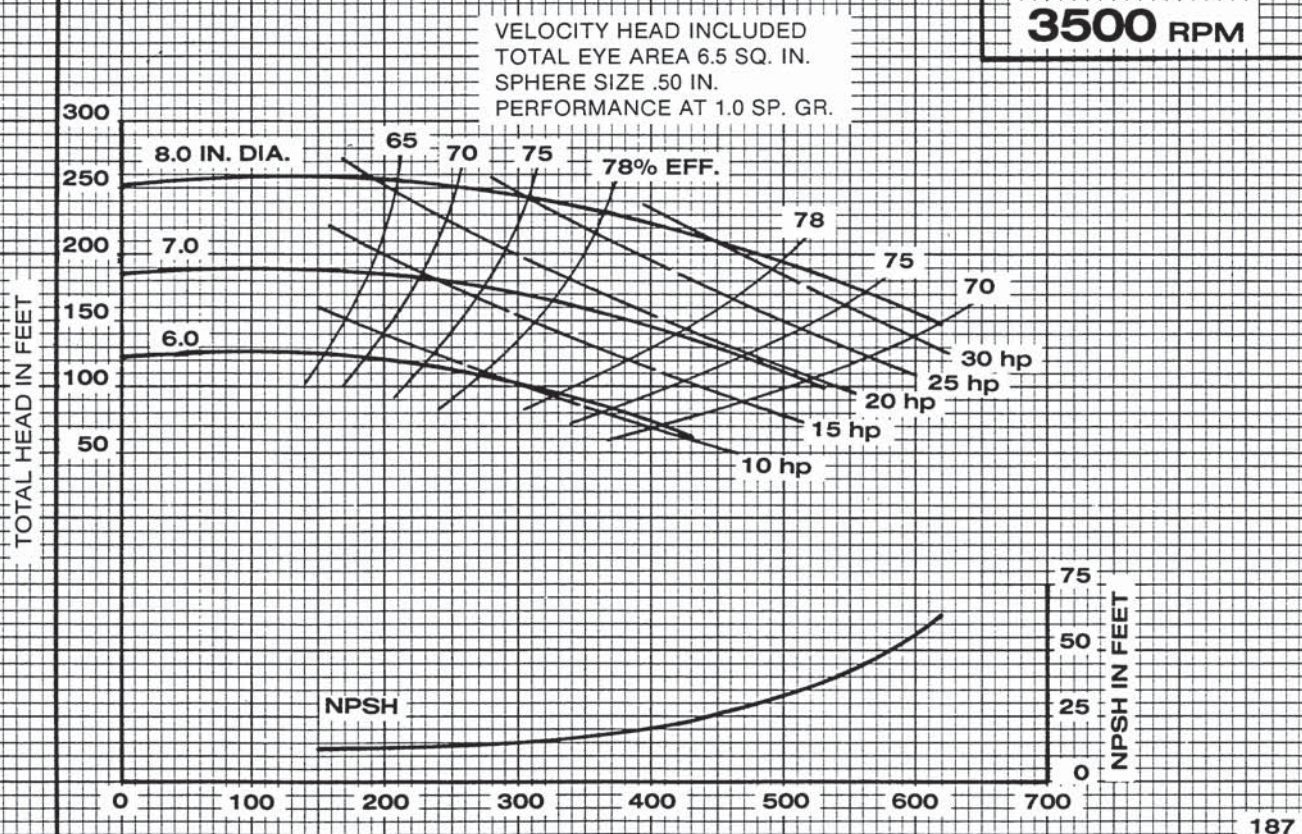

IMPELLER **2683748**

U.S. GALLONS PER MINUTE

CURVE **3115058**